

For Lease or Sale

12339 SE STARK ST

*16,129 SF Free Standing
Retail Building*



12339 SE STARK ST, PORTLAND, OR 97233

km Kidder
Mathews



Free standing retail building with large monument signage, high ceilings, ample on-site parking, and fully sprinklered.

SF AVAILABLE	16,129 SF
DATE AVAILABLE	Q2 2024
LOT SIZE	1.36 acres
YEAR BUILT	1983
TRAFFIC COUNTS	38,504 VPD (SE Stark St & SE 122nd Ave)
PARKING	4.84/1,000 SF
ZONING	CM3 (Commercial Mixed Use 3)
FIRE	Fully sprinklered

\$2.25M
SALE PRICE

CALL
LEASE RATE

SITE PLAN

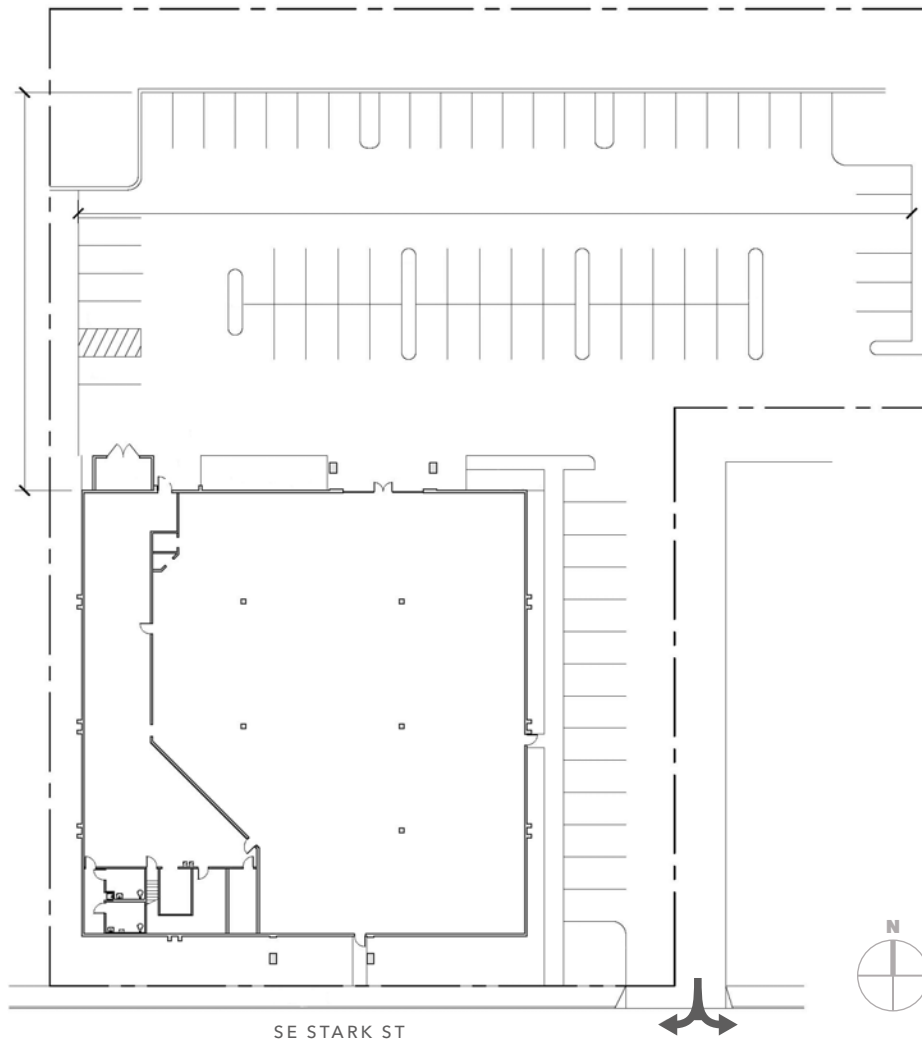

16,129 SF

AVAILABLE

4.84/1,000

PARKING RATIO

1.36 AC

LOT SIZE



HIGHLY- ACCESSIBLE LOCATION

Close to The Home Depot, Target, Winco, Glendoveer Golf Course, and Ventura Park

Close to MAX line

Located in a dense retail corridor and surrounded by residential neighborhoods

16 MIN

PORTLAND CBD

13 MIN

PDX AIRPORT

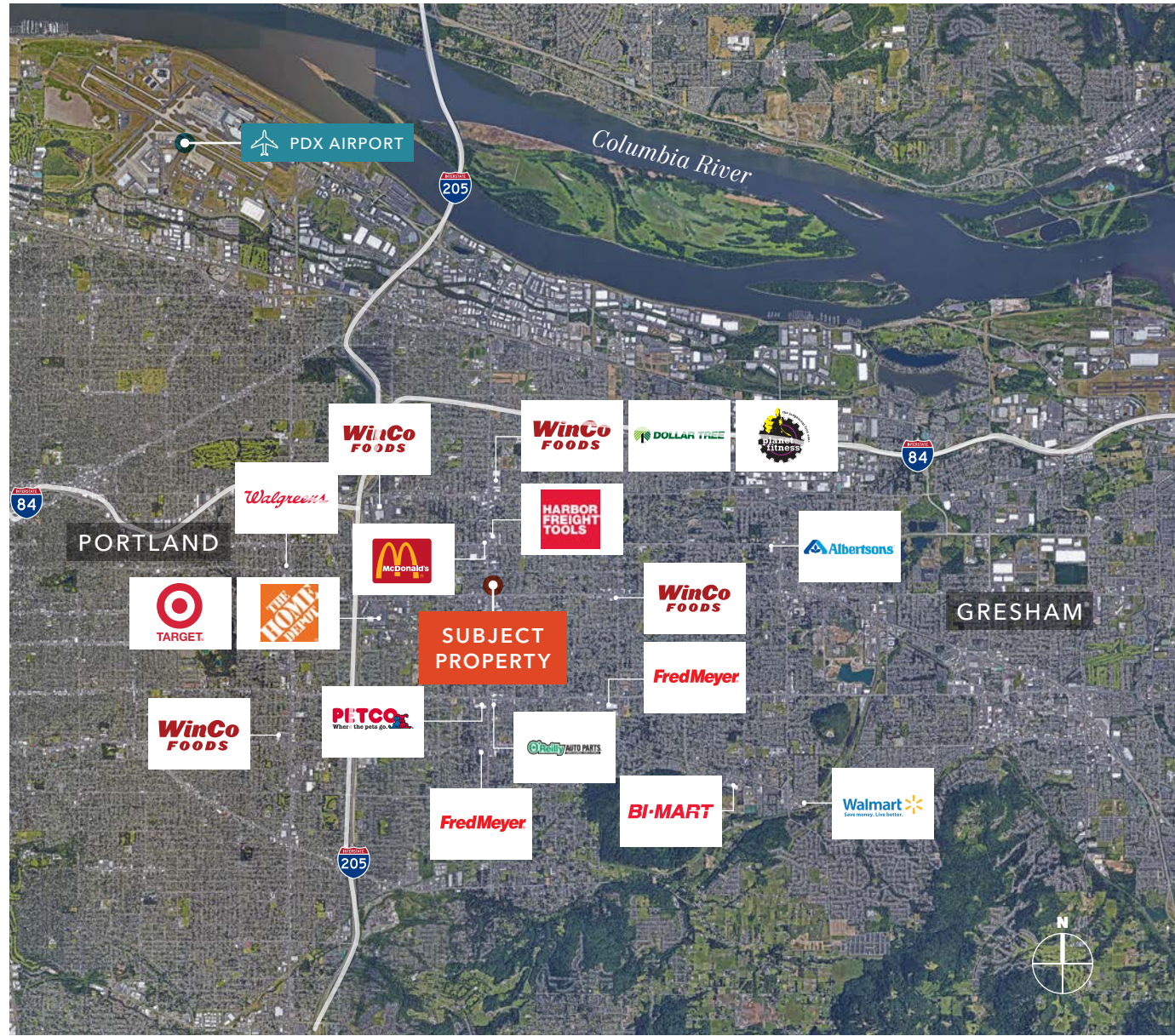

DEMOGRAPHICS

POPULATION

	1 Mile	3 Miles	5 Miles
ESTIMATED 2023	24,089	182,121	396,078
CENSUS 2020	24,623	184,877	401,468
PROJECTED 2028	23,716	180,141	398,140

LABOR FORCE

	1 Mile	3 Miles	5 Miles
WORKER BASE	12,700	91,346	212,034
TOTAL BUSINESSES	1,084	7,572	19,158
TOTAL EMPLOYEES	8,806	54,525	134,931

HOUSEHOLD INCOME

	1 Mile	3 Miles	5 Miles
2023 MEDIAN	\$69,427	\$71,161	\$83,859
2028 MEDIAN PROJECTED	\$70,857	\$72,498	\$86,175
2023 AVERAGE	\$92,255	\$96,963	\$113,405
2028 AVERAGE PROJECTED	\$99,614	\$104,241	\$119,322

Data Source: Regis ©2023, Sites USA

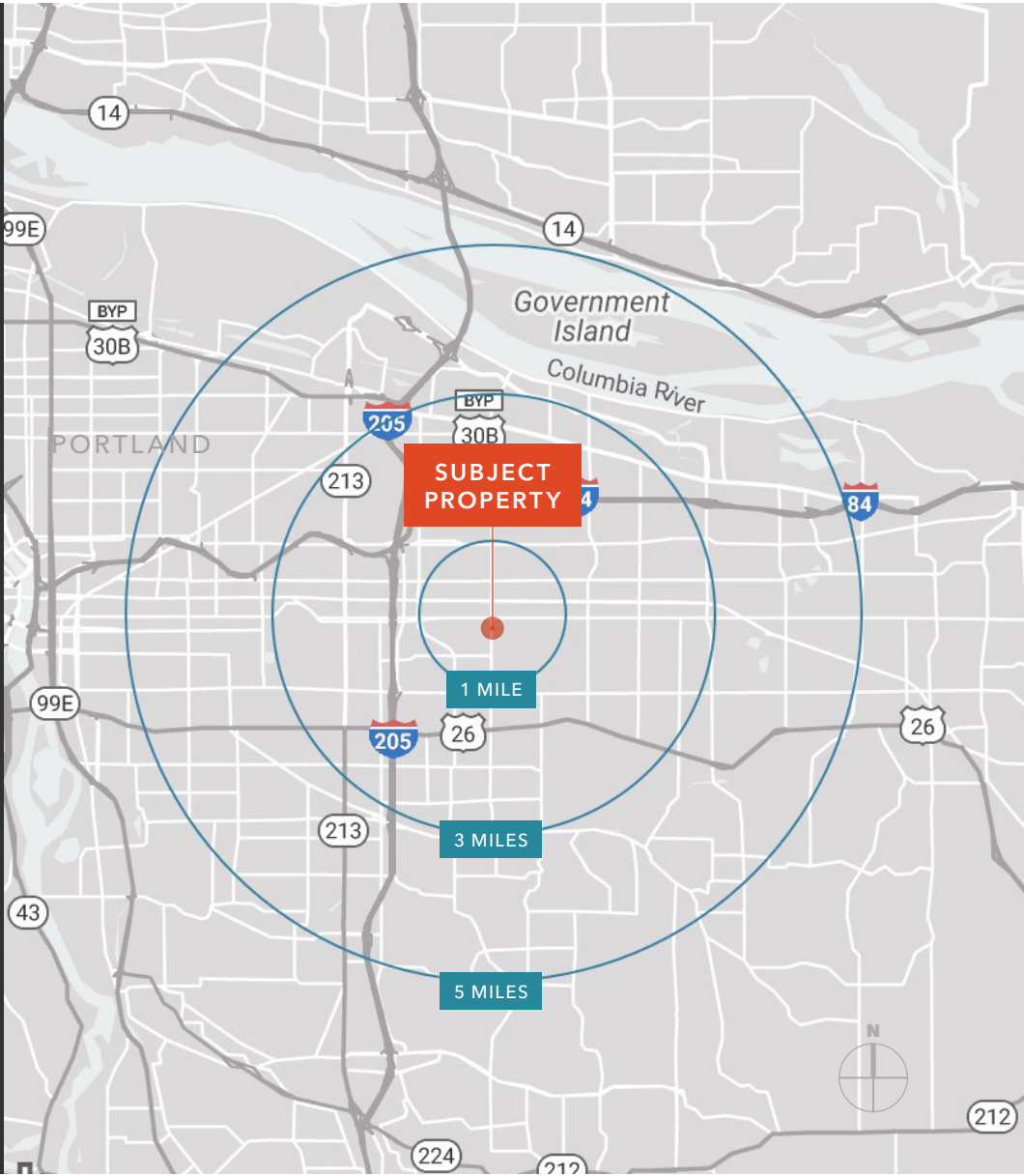

12339
SE STARK ST

Exclusively listed by

RYAN O'LEARY
503.221.2294
ryan.oleary@kidder.com

REBECCA O'LEARY, CCIM
503.221.2279
rebecca.oleary@kidder.com

KIDDER.COM | TEAMOLEARY.COM

This information supplied herein is from sources we deem reliable. It is provided without any representation, warranty, or guarantee, expressed or implied as to its accuracy. Prospective Buyer or Tenant should conduct an independent investigation and verification of all matters deemed to be material, including, but not limited to, statements of income and expenses. Consult your attorney, accountant, or other professional advisor.

